

Nose Assemblies

Selection

There are two types of nose assemblies available, straight and offset. Choose the type most suitable according to the access restrictions on your application. It is essential that the correct nose assembly is fitted prior to operating the tool.

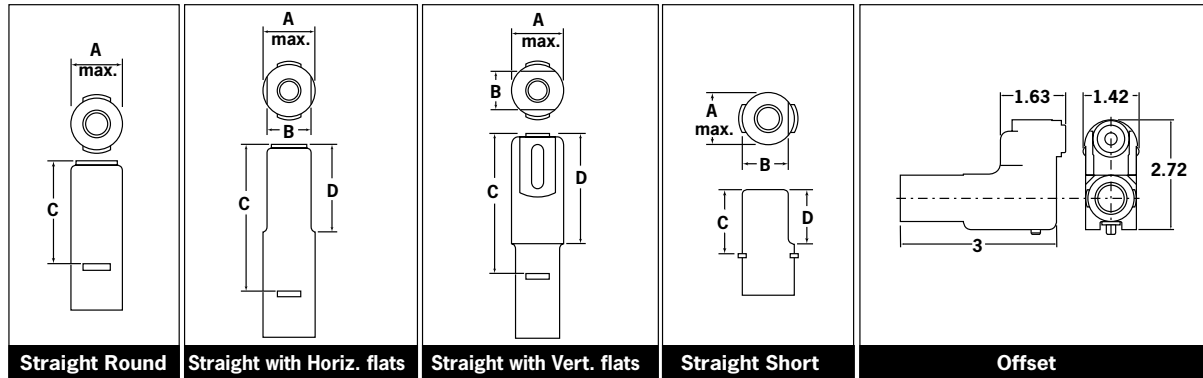

07220 NOSE ASSEMBLY SELECTION										
AVDELOK® SIZE	NOSE ASSEMBLY DESCRIPTION	A mm	A inch	B mm	B inch	C mm	C inch	D mm	D inch	NOSE ASSY. PART N ^o
3/16"	Straight with Horizontal Flats	21	.812	16	.625	54	2.12	25	1.0	07200-02700 *
	Straight with Vertical Flats	21	.812	16	.625	54	2.12	25	1.0	07200-02500 *
	Offset	-	-	-	-	-	-	-	-	07220-02800
1/4"	Straight Round	21	.812	-	-	54	2.12	-	-	07200-03500 *
	Straight with Horizontal Flats	21	.812	16	.625	54	2.12	25	1.0	07200-02800 *
	Straight with Horizontal Flats (Stepped)	21	.812	16	.625	54	2.12	25	1.0	07200-03300 *
	Straight with Vertical Flats	21	.812	16	.625	54	2.12	25	1.0	07200-02600 *
5/16"	Offset	-	-	-	-	-	-	-	-	07220-02900
	Straight Round	27	1.06	-	-	91	3.58	-	-	07220-05600
	Straight with Horizontal Flats	27	1.06	23.6	.930	91	3.58	40	1.58	07220-02700
3/8"	Straight with Horizontal Flats (Stepped)	27	1.06	22.6	.890	94	3.70	46	1.83	07220-03400
	Straight Round	27	1.06	-	-	70	2.75	-	-	07220-02000
	Straight Round (Stepped)	21	.812	-	-	74.2	2.92	-	-	07220-03500
3/8"	Straight Short	27	1.06	25.2	.992	37	1.45	32	1.25	07220-06100

*It is necessary to use an adaptor (part number 07220-02500) to fit these nose assemblies to the tool.

Stepped anvils give a less severe deformation of the collars thus allowing placing of Avdelok® in softer materials like plastics, wood, etc.

Fitting Instructions

IMPORTANT

The air supply must be disconnected when fitting or removing nose assemblies unless specifically instructed otherwise.

Nose assemblies must be assembled before fitting. Offset nose assemblies are always supplied assembled.

STRAIGHT HORIZONTAL, VERTICAL OR ROUND NOSE ASSEMBLIES

- Lightly coat the jaws with Moly Lithium grease.
- Assemble Spring Guides **4** and Spring **5** and stand on end on a flat even surface.
- Balance the three Chuck Jaws **3** on the upper Spring Guide **4** (using a spent pintail to aid positioning if necessary).
- Carefully lower Chuck Collet **2** over the assembled components.
- Insert Spacer **6** (if required) into Chuck Collet **2** (5/16" dia only).
- Assembly can then be located in anvil.

Item numbers in **bold** refer to the drawing opposite.

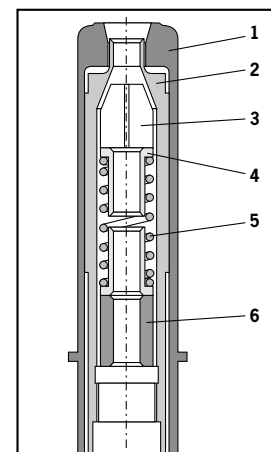

Nose Assemblies

Fitting Instructions

- To assemble short nose assemblies 07220-06100, lightly coat the jaws with Moly Lithium grease.
- Drop three Chuck Jaws **11** into Chuck Collet **12**.
- Place Follower Cap **9**, Spring **13** and Washer **14** into Chuck Collet **12**.
- Assembly can then be located in anvil

When using $\frac{3}{16}$ " and $\frac{1}{4}$ " nose assemblies, it is necessary to first fit an adaptor part number 07220-02500 to the tool.

- To fit the reducing adaptor to the tool, pull forward and rotate through 90° the outer ring of the head extension assembly on the tool to expose slots.
- Screw the collet adaptor onto the head piston.
- Insert $\frac{3}{8}$ " A/F Allen key* into the back of the tool and into the piston head to stop rotation of the piston and tighten the collet adaptor with a spanner*.
- Push the anvil adaptor onto the tool, ensuring that the lugs on the body enter the slots in the head extension of the tool .
- Turn the reducing adaptor body through 90 ° then turn the head extension ring until it springs into its position in the slots of the head extension.
- The $\frac{3}{16}$ " and $\frac{1}{4}$ " straight nose assemblies can now be fitted to the tool.

To fit the nose assemblies either direct to the tool or to the adaptor, proceed as follows:

- Pull forward and rotate through 90° the outer ring of the head extension assembly (or outer ring of 07220-02500 if fitted).
- Insert a $\frac{3}{8}$ " A/F Allen key* into the back of the tool and into the piston head.
- Holding the tool pointing downwards, screw the assembly firmly onto the tool using a spanner*, except for the offset nose assembly.
- For straight nose assemblies, place the integral anvil over the chuck collet, ensuring the lugs on the anvil enter the slots on the head extension (or adaptor) .
- Engage lugs on nose assembly to mate with slots on head extension and turn through 90°.
- The offset nose assembly can be turned to the angle required.
- Turn head extension ring through 90° until it springs into position in the slots of the head extension sleeve.

Servicing Instructions

Nose assemblies should be serviced at weekly intervals.

- For straight nose assemblies, remove using the reverse procedure to the 'Fitting Instructions'.
- Particularly check wear on jaws.
- Ensure spring and spring guides (if fitted) are not worn or distorted.
- To dismantle offset nose assembly follow the next six steps.
- Remove cover Screws **30** and Cover **31**.
- Remove Retaining Ring **17**.
- On $\frac{3}{16}$ " offset adaptor only, remove Washer **18** and 'O' Ring **20**.
- Remove Nylon Washer **19**.
- Remove Jaws **23** from Insert **24**.
- Remove 'O' Ring **21** from groove in Jaws **23**.
- Clean and inspect components, renewing worn or damaged items.
- Assemble in reverse order to dismantling.

*Refers to items included in the 07220 Service Kit. For complete list see page 14.
Item numbers in **bold** refer to the drawings and parts list on page 12.

Nose Assemblies

Components

Each nose assembly represents a unique assembly of components which can be ordered individually. Component numbers refer to the illustrations. We recommend some stock as items will need regular replacement. Read the Nose Assemblies servicing instructions carefully.

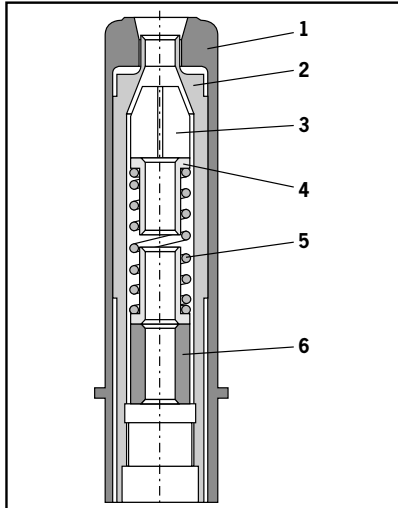

COMPONENT PART NUMBERS OF ROUND, HORIZONTAL FLATS AND VERTICAL FLATS STRAIGHT NOSE ASSEMBLIES						
DESCRIPTION	ANVIL	CHUCK COLLET	CHUCK JAWS	SPRING GUIDE	SPRING	SPACER
ITEM Nº 1	2	3	4	5	6	-
QTY	1	3	2	1	1	-
NOSE ASSY						
07200-02500	07200-02501	07200-02101	07220-02102	07220-02104	07220-02103	-
07200-02600	07200-02601	07200-02201	07220-02302	07220-02104	07220-02103	-
07200-02700	07200-02701	07200-02101	07220-02102	07220-02104	07220-02103	-
07200-02800	07200-02801	07200-02201	07220-02302	07220-02104	07220-02103	-
07200-03300	07200-03301	07200-03302	07220-02302	07220-02104	07220-02103	-
07200-03500	07200-03501	07200-02201	07220-02302	07220-02104	07220-02103	-
07220-02000	07220-02001	07220-02002	07220-02003	07220-02603	07220-02605	-
07220-02700	07220-02601	07220-02701	07220-02606	07220-02603	07220-02605	07220-02604
07220-03400	07220-03401	07220-03402	07220-02606	07220-02603	07220-02605	07220-02604
07220-03500	07220-03501	07220-03502	07220-02003	07220-02603	07220-02605	-
07220-05600	07220-05401	07220-02701	07220-02606	07220-02603	07220-02605	07220-02604

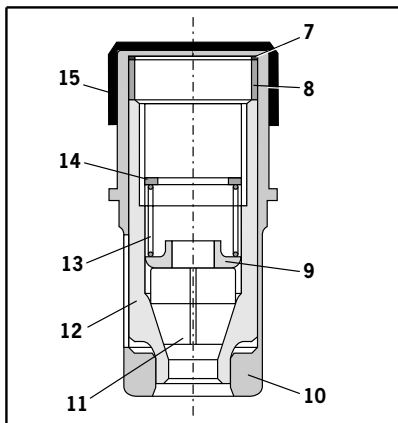

COMPONENT PART NUMBERS OF SHORT NOSE ASSEMBLIES 07220-06100			
ITEM Nº	DESCRIPTION	PART NUMBER	QTY
7	SHIM	07220-06106	1
8	LOCK COLLAR	07220-06105	1
9	FOLLOWER CAP	07220-06107	1
10	ANVIL	07220-06103	1
11	CHUCK JAW	07220-02003	3
12	CHUCK COLLET	07220-06104	1
13	SPRING	07220-06101	1
14	WASHER	07220-06102	1
15	PROTECTIVE CAP	07220-02108	1

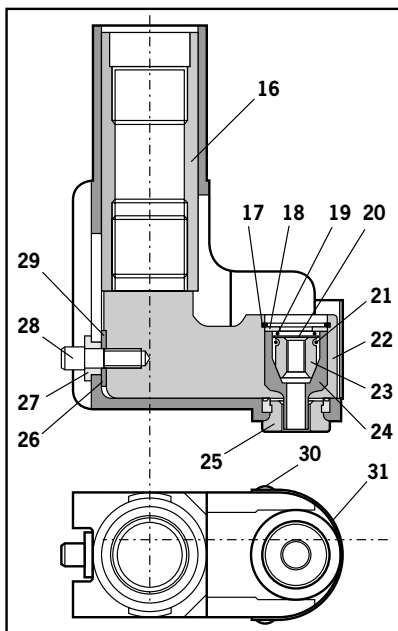

COMPONENT PART NUMBERS OF OFFSET NOSE ASSEMBLIES				
ITEM Nº	DESCRIPTION	NOSE ASSY 07220-02800	NOSE ASSY 07220-02900	QTY
16	ADAPTOR SLEEVE	07220-02805	07220-02805	1
17	RETAINING RING	07004-00010	07004-00010	1
18	WASHER	07220-02811	07220-02811	1
19	NYLON WASHER	07220-02816	-	1
20	'O' RING	07003-00026	-	1
21	'O' RING	07003-00030	07003-00030	1
22	OPERATING ARM	07220-02809	07220-02809	1
23	JAWS	07220-02815	07220-02902	3
24	INSERT	07220-02810	07220-02903	1
25	ANVIL	07220-03200	07220-03300	1
26	SHIM	07220-02813	07220-02813	1
27	LOCATING BUSH	07220-02807	07220-02807	1
28	SCREW	07220-02814	07220-02814	1
29	PAD	07220-02812	07220-02812	1
30	COVER SCREWS	07001-00010	07001-00010	2
31	COVER	07220-02804	07220-02804	1