

*Positive external locking feature. Requires special nosetip.
Good vibration and water resistance. Available in a variety of materials and headstyles.*

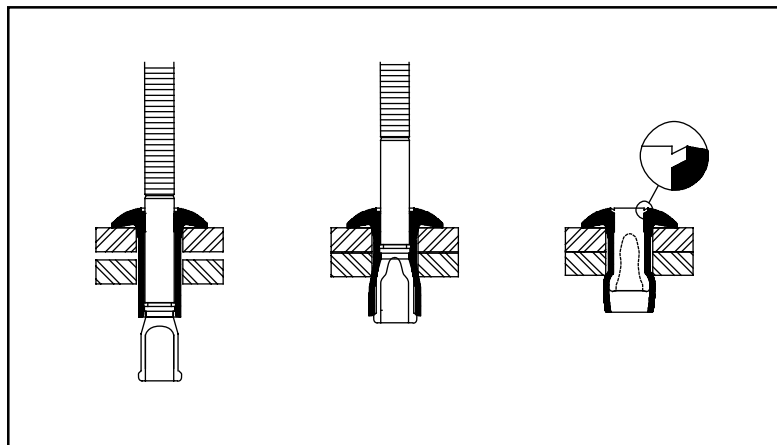

Benefits

- **Visible Lock**
External locking mechanism for positive stem retention.
- **High Clamp-up**
Removes gap between sheets easily.
- **Complete Hole Fill and Sealing Capability**
Expands radially during setting to fill even elliptical holes.
- **High Shear and Tensile**
Resists loosening when exposed to variable loads.



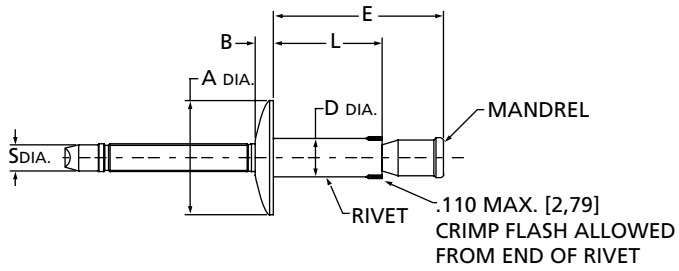

Large Flange Head

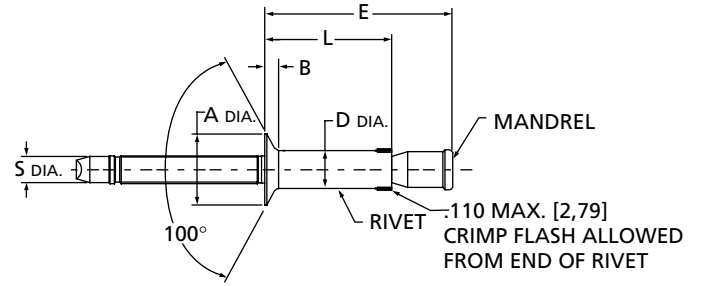

Countersunk Head

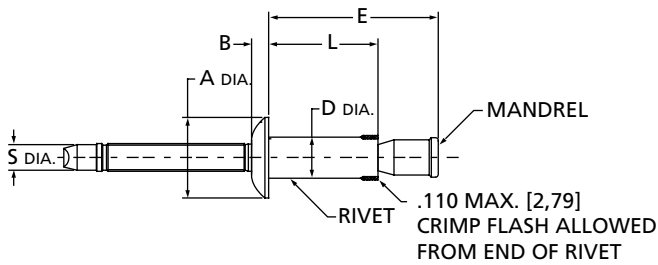

Protruding Head

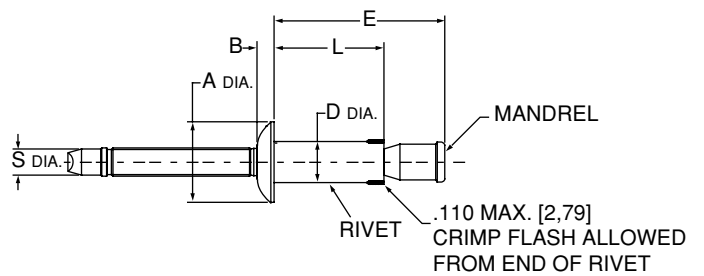

Brazier Head

Diam.	Series	Hole Size	D Diam.	Protruding		Large Flange Protruding		Countersunk		Brazier	
				A	B Max.	A	B Max.	A	B Ref.	A	B Max.
3/16" (4,8mm)	AVDEL 2711 CHERRY CCPV	.194-.204 (4,93-5,18)	.184-.193 (4,67-4,90)	.355-.400 (9,02-10,16)	.090 (2,29)						
	AVDEL 2771 CHERRY SSPV			.355-.400 (9,02-10,16)	.090 (2,29)						
	AVDEL 2774 CHERRY BAPV			.355-.400 (9,02-10,16)	.090 (2,29)						
	AVDEL 2794 CHERRY SSLVA					.500-.530 (12,70-13,46)	.105 (2,67)				
	AVDEL 2761 CHERRY SSCV							.325-.360 (8,26-9,14)	.070 (1,78)		
1/4" (6,3mm)	AVDEL 2711 CHERRY CCPV	.261-.276 (6,63-7,01)	.254-.260 (6,45-6,60)	.480-.530 (12,19-13,46)	.117 (2,97)						
	AVDEL 2771 CHERRY SSPV			.480-.530 (12,19-13,46)	.117 (2,97)						
	AVDEL 2774 CHERRY BAPV			.480-.530 (12,19-13,46)	.117 (2,97)						
	AVDEL 2761 CHERRY SSCV							.395-.448 (10,03-11,38)	.079 (2,01)		
	AVDEL ----- CHERRY BABV									.454-.484 (11,53-12,29)	.094 (2,39)

BAPV-06-04

IDENTIFICATION CODE:

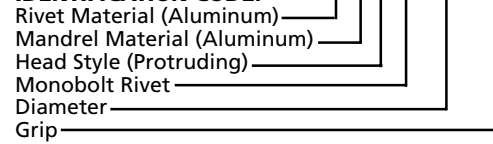

Rivet Diam.	G Grip Range	L Max.	E Max.	S	Series	2711 CCPV St. Steel	2771 SSPV Steel	2761 SSCV Steel	2774 BAPV Alum.	BABV Alum.	2794 SSLVA Steel
3/16" (4,8mm)	.062-.250 (1,57-6,35)	.416 (10,57)	.842 (21,39)	.114-.120 (2,90-3,05)	AVDEL- CHERRY-	2711-0613 CCPV-06-04	2771-0613 SSPV-06-04		2774-0613 BAPV-06-04		2794-0613 SSLVA-06-04
	.064-.437 (1,63-11,10)	.577 (14,66)	.962 (25,43)		AVDEL- CHERRY-	2711-0617 CCPV-E06-07	2771-0617 SSPI-E06-07		2774-0617 BAPV-E06-07		2794-0617 SSLVA-E06-07
	.125-.331 (3,18-8,41)	.486 (12,34)	.800 (20,32)		AVDEL- CHERRY-			SSCV-06-06			
1/4" (6,3mm)	.080-.375 (2,03-9,53)	.556 (14,12)	1.181 (30,00)	.153-.162 (3,89-4,11)	AVDEL- CHERRY-	2711-0817 CCPV-08-06	2771-0817 SSPV-08-06		2774-0817 BAPV-08-06		
	.350-.625 (8,89-15,87)	.806 (2,047)	1.431 (36,85)		AVDEL- CHERRY-	2711-0824 CCPV-E08-10	2771-0824 SSPV-E08-10		2774-0824 BAPV-E08-10		
	.125-.475 (3,18-12,07)	.660 (16,76)	1.028 (26,11)		AVDEL- CHERRY-			SSCV-08-08			
	.080-.375 (2,03-9,53)	.556 (14,12)	1.181 (30,00)		AVDEL- CHERRY-					BABV-08-06	

NOTES:

1. Monobolts are supplied lubricated and must not be degreased.
2. To install Avdel or Cherry fasteners, the use of Textron Fastening Systems-specified installation tooling is recommended.

Minimum Rivet Shear and Tensile and Mandrel Retention Avdel Cherry Monobolt Rivet lbs. f (N)									
Rivet Diam.	BA Series Aluminum Rivet Aluminum Mandrel IFI Grade 12			SS Series Steel Rivet Steel Mandrel IFI Grade 30			CC Series Stainless Steel Rivet Stainless Steel Mandrel IFI Grade 51		
	Shear	Tensile	Mandrel Push-Out	Shear	Tensile	Mandrel Push-Out	Shear	Tensile	Mandrel Push-Out
3/16" (4,8mm)	550 (2446)	450 (2002)	50 (222)	1300 (5782)	1000 (4448)	100 (445)	1300 (5782)	1000 (4448)	100 (445)
1/4" (6,3mm)	1270 (5649)	830 (3692)	100 (445)	2400 (10675)	1850 (8229)	250 (1112)	2400 (10675)	1850 (8229)	250 (1112)

Series	Head Style	Material		Finish	
		Body	Stem	Body	Stem
AVDEL 2711 CHERRY CCPV	Protruding	Stainless Steel	Stainless Steel	Bright	Bright
AVDEL 2771 CHERRY SSPV	Protruding	Steel	Steel	Zinc Plate & Clear Chromate	Zinc Plate & Yellow Chromate
AVDEL 2774 CHERRY BAPV	Protruding	Aluminum	Aluminum	Natural	Natural
AVDEL 2794 CHERRY SSLV	Large Flange Protruding	Steel	Steel	Zinc Plate & Clear Chromate	Zinc Plate & Yellow Chromate
AVDEL 2761 CHERRY SSCV	Countersunk	Steel	Steel	Zinc Plate & Clear Chromate	Zinc Plate & Yellow Chromate
AVDEL ----- CHERRY BABV	Brazier	Aluminum	Aluminum	Natural	Natural