

# KLAMP-TITE® Fastening System Structural

Product Information

*External locking feature for Structural Klamp-tite® requires special nosetip.  
Provides good vibration resistance. Exceptional clamp-up strength. Wide grip range.  
Three-leg formation compensates for oversized or irregular holes.*



## **Benefits:**

- **Visible Lock**  
When using the prescribed nosetip, the rivet stem and body are physically and visibly locked. This provides good vibration resistance and allows inspection of the lock, ensuring a quality fastened joint.
- **Grip Tolerant**  
Will fasten materials over a wide range of sheet thicknesses.
- **Sealing Capability**  
With the use of an optional rubber washer, this fastener can be made to effect a weather-resistant seal.
- **Hole Preparation**  
The three legs of the Klamp-tite rivet provide a large blind-side bearing surface over which to distribute loads.

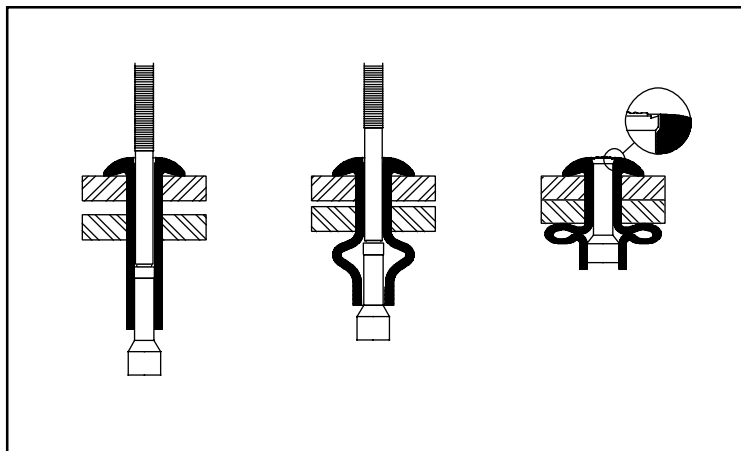

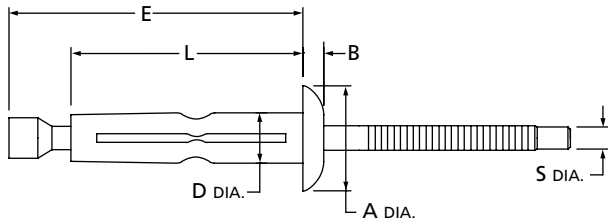

Structural

**BAPKTR-06-06**

**IDENTIFICATION CODE:**  
 Rivet Material (Aluminum)  
 Mandrel Material (Aluminum)  
 Head Style (Protruding)  
 Klamp  
 Tite  
 Rivet  
 Rivet Diameter in 32nds of an inch.  
 Rivet Nominal Grip Length in 16ths of an inch

Rivet Diam.	BA Series Aluminum Body Aluminum Stem lbs. f (N)		
	Shear	Tensile	Stem Retention*
<b>(6) 3/16"</b> <b>(4,8mm)</b>	700 (3113)	450 (2001)	50 (222)
<b>(8) 1/4"</b> <b>(6,4mm)</b>	1250 (6004)	700 (4447)	100 (445)

\*Shear and tensile values are those to be typically expected. Retention values are the minimum to be expected when installed properly.

Nom. Rivet Diam.	Hole Size	Drill Number	S Stem Diam.	D Sleeve Diam.	Protruding Head		Countersunk Head	
					A Head Diam.	B Head Thick.	A Head Diam.	B Head Thick.
<b>(6) 3/16"</b> <b>(4,8mm)</b>	.204-.209" (5,18-5,31)	#5	.103 (2,62)	.197 (5,00)	.445 (11,30)	.088 (2,24)	.335 (8,51)	.070 (1,78)
<b>(8) 1/4"</b> <b>(6,4mm)</b>	.252-.262" (6,40-6,65)	F	.136 (3,45)	.242 (6,15)	.560 (14,22)	.113 (2,87)		

Note: L & E dimensions vary with each grip length. (See the "Part Selection" table below.)

Rivet Diam.	G Rivet Grip Range		L Rivet Length Max.		E Blind Length Max.		Series BA Aluminum Rivet Aluminum Stem	
	Inch	mm.	Inch	mm.	Inch	mm.	Prtrd. Head	Ctsk. Head
<b>3/16"</b> <b>(4,8mm)</b> <b>(6)</b>	.050-.250	1,27-6,35	.890	22,61	1.21	30,74	BAPKTR-06-04	
	.187-.375	4,75-9,53	.985	25,02	1.30	33,02	BAPKTR-06-06	BACKTR-06-06
	.375-.562	9,53-14,27	1.12	28,45	1.43	36,32	BAPKTR-06-09	
	.562-.750	14,27-19,05	1.30	33,02	1.62	41,15	BAPKTR-06-12	BACKTR-06-12
<b>1/4"</b> <b>(6,4mm)</b> <b>(8)</b>	.060-.250	1,52-6,35	.925	23,50	1.30	33,02	BAPKTR-08-04	
	.187-.375	4,75-9,53	1.05	26,67	1.42	36,07	BAPKTR-08-06	

Note: The structural Klamp-Tite® rivet must always be installed using nosetip number 743C53 or 743C51 for 3/16" and 1/4" diameters, respectively. The pulling head of the installation tool should incorporate a 3-jaw system.

**Notes:**

1. Items listed on these pages reflect our manufacturing capability.
2. Finishes: aluminum stems, and rivets are coated with a wax lubricant.
3. Weather resistance can be obtained by specifying a synthetic rubber washer under protruding head fasteners (i.e.. BAPKTR-6W6)