

Chobert® 1124 / 1132 /1136

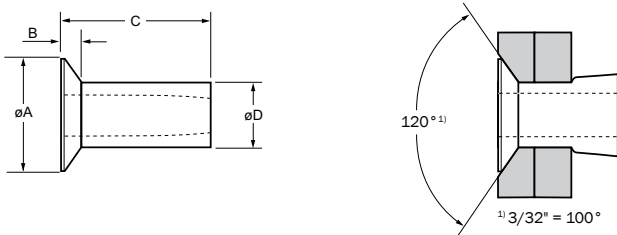

For installation information please refer to the tooling overview and manuals on our website www.avdel-global.com.
 Pour les conditions de pose, merci de vous référer à la description de l'outil et aux manuels disponibles sur notre site Web.
 Angaben zur Verarbeitung entnehmen Sie bitte der Geräteübersicht und den Betriebsanleitungen auf unserer Website.
 Per informazioni sull'installazione preghiamo consultare i manuali e la panoramica degli attrezzi sul nostro sito web.
 Para ver información sobre máquinas de colocación, consulte nuestra página web, apartados visión general de máquinas y manuales.

English	Français	Deutsch	Italiano	Español
Countersunk head	Tête fraisée	Senkkopf	Testa svasata	Cabeza avellanada
Aluminium alloy	Alliage d'aluminium	Aluminium	Lega di alluminio	Aluminio
Natural	Brut	Blank	Nessuna finitura	Natural



ø	Cross-section		Thread		øA	B	C	øD	Fasteners per pod/ Nombre de rivets par chargeur / Niete pro Magazin/ Rivetti per caricatore / Uds./carga	Aluminium		
	min.	max.	min.	max.						2.5 % Mg AA 5052 DIN 1725 AlMg2.5 Werkstoff 3.3523	3.5 % Mg BS 1473 5154A DIN 1725 AlMg3.5 Werkstoff 3.3535	5 % Mg BS 1473 5056A DIN 1725 AlMg5 Werkstoff 3.3555
nom.	min.	max.	min.	max.	min.	max.	max.	max.	± 1	Part No/ref	Part No/ref	Part No/ref
3/32"		.062	.098	.1005	.164	.035	.130	.097	90	01124-00304	01132-00304	
		.125					.192		61	01124-00306	01132-00306	
		.187					.255		46	01124-00308	01132-00308	
		.250					.317		37		01132-00310	
		.312					.380		31		01132-00312	
1/8"		.062	.1285	.1315	.205	.036	.130	.128	90	01124-00404	01132-00404	01136-00404
		.125					.192		61	01124-00406	01132-00406	01136-00406
		.187					.255		46	01124-00408	01132-00408	01136-00408
		.250					.317		37	01124-00410	01132-00410	01136-00410
		.312					.380		31	01124-00412	01132-00412	01136-00412
5/32"		.125	.161	.164	.245	.038	.192	.159	61	01124-00506	01132-00506	01136-00506
		.187					.255		46	01124-00508	01132-00508	01136-00508
		.250					.317		37	01124-00510	01132-00510	01136-00510
		.312					.380		31	01124-00512	01132-00512	01136-00512
		.375					.442		26	01124-00514	01132-00514	01136-00514
		.437					.505		23	01124-00516	01132-00516	01136-00516

all dimensions in inches / en pouces / alle Maße in Zoll / in pollici / en pulgadas



Chobert® 1124 / 1132 /1136

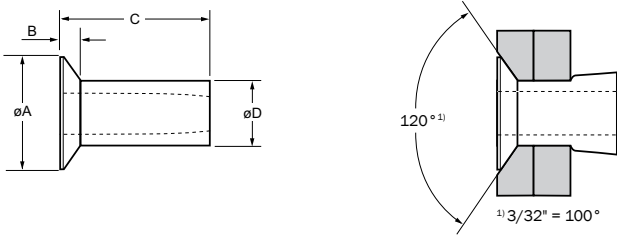

ø	Cross-section		Thread		øA	B	C	øD	Fasteners per pod/ Nombre de rivets par chargeur / Niete pro Magazin/ Rivetti per caricatore / Uds./carga	Aluminium		
	min.	max.	min.	max.						2.5 % Mg AA 5052 DIN 1725 AlMg2.5 Werkstoff 3.3523	3.5 % Mg BS 1473 5154A DIN 1725 AlMg3.5 Werkstoff 3.3535	5 % Mg BS 1473 5056A DIN 1725 AlMg5 Werkstoff 3.3555
nom.	min.	max.	min.	max.	min.	max.	max.	max.	± 1	Part No/ref	Part No/ref	Part No/ref
3/16"	.062	.125	.191	.194	.339	.056	.224	.189	52	01124-00607	01132-00607	01136-00607
	.125	.187					.286		41	01124-00609	01132-00609	01136-00609
	.187	.250					.349		33	01124-00611	01132-00611	01136-00611
	.250	.312					.411		28	01124-00613	01132-00613	01136-00613
	.312	.375					.474		25	01124-00615	01132-00615	01136-00615
	.375	.437					.536		22	01124-00617	01132-00617	01136-00617
	.437	.500					.599		19	01124-00619	01132-00619	01136-00619
1/4"	.125	.187	.250	.253	.401	.057	.286	.248	41	01124-00809	01132-00809	01136-00809
	.187	.250					.349		33	01124-00811	01132-00811	01136-00811
	.250	.312					.411		28	01124-00813	01132-00813	01136-00813
	.312	.375					.474		25	01124-00815	01132-00815	01136-00815
	.375	.437					.536		22	01124-00817	01132-00817	01136-00817
	.437	.500					.599		19	01124-00819	01132-00819	01136-00819

all dimensions in inches / en pouces / alle Maße in Zoll / in pollici / en pulgadas

ø	Strength		
	Series 01124	Series 01132	Series 01136
nom.	lbf ¹⁾	lbf ¹⁾	lbf ¹⁾
3/32"	67	112	112
1/8"	135	202	202
5/32"	225	360	360
3/16"	337	450	450
1/4"	427	607	607

1) typical values / valeurs moyennes / typische Werte / Valori tipici / resistencias máximas recomendadas