



English	Français	Deutsch	Italiano	Español
Dome head	Tête plate	Flachrundkopf	Testa tonda	Cabeza alomada
Brass* Electro tin plated	Laiton* Etamage électrolytique	Kupfer-Zink Legierung* verzinkt	Ottone* Stagnato	Latón* Estantado electrolítico

*: BS EN 12166 CW 508L DIN 17660 CuZn37

Option:



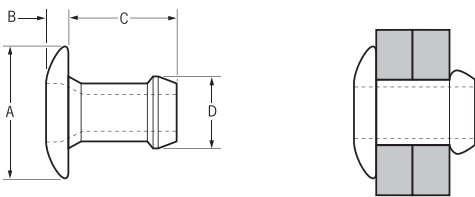

For brightened Brass finish replace 01833 with 01831 / Pour finition brillante remplacer la série 01833 par 01831 / Für Oberfläche blank ersetzen Sie 01833 durch 01831 / Per finitura brillante sostituire 01833 con 01831 / Con acabado brillante cambiar 01833 por 01831



nom.	Ø		Pitch		A	B	C	D	lb ^{f1)}	lb ^{f1)}	Fasteners per pod / Nombre de rivets par chargeur / Niete pro Magazin / Rivetti per caricatore / Uds./carga ± 1	Part No/ref
	min.	max.	min.	max.	max.	max.	max.	max.				
3/32"	.045	.095	.0930	.0960	.162	.035	.157	.0924	100	200	64	01833-00304
	.085	.135					.197				52	01833-00306
	.125	.175					.237				44	01833-00308
	.165	.215					.277				38	01833-00310
	.205	.255					.317				34	01833-00312
	.245	.295					.357				30	01833-00314
	.265	.315					.377				28	01833-00315
	.285	.335					.397				27	01833-00316
1/8"	.305	.355	.1285	.1315	.257	.039	.417	.1243	250	430	26	01833-00317
	.025	.075					.152				64	01833-00403
	.045	.095					.172				58	01833-00404
	.085	.135					.212				50	01833-00406
	.125	.175					.252				42	01833-00408
	.165	.215					.292				37	01833-00410
	.205	.255					.332				33	01833-00412
	.245	.295					.372				29	01833-00414
.285	.335	.412	26	01833-00416								

all dimensions in inches / en pouces / alle Maße in Zoll / in pollici / en pulgadas

1) typical values / valeurs moyennes / typische Werte / Valori tipici / resistencias máximas recomendadas

ø					A	B	C	D			Fasteners per pod / Nombre de rivets par chargeur / Niete pro Magazin / Rivetti per caricatore / Uds./carga ± 1	Part No/ref
	nom.	min.	max.	min.	max.	max.	max.	max.	max.	lb ^{f1}		
5/32"	.062	.115	.1562	.1592	.322	.039	.193	.1533	420	620	52	01833-00505
	.085	.135					.213				48	01833-00506
	.105	.155					.233				44	01833-00507
	.145	.195					.273				38	01833-00509
	.185	.235					.313				34	01833-00511
	.225	.275					.353				30	01833-00513
	.265	.315					.393				27	01833-00515
	.305	.355					.433				25	01833-00517
3/16"	.065	.130	.1910	.1940	.382	.046	.121	.1885	520	810	46	01833-00606
	.080	.155					.240				42	01833-00607
	.145	.205					.290				35	01833-00609
	.195	.255					.340				31	01833-00611
	.245	.305					.390				27	01833-00613
	.295	.355					.440				24	01833-00615
	.345	.405					.490				22	01833-00617
	.395	.455					.530				20	01833-00619

all dimensions in inches / en pouces / alle Maße in Zoll / in pollici / en pulgadas

1) typical values / valeurs moyennes / typische Werte / Valori tipici / resistencias máximas recomendadas