

Briv[®] 1821



For installation information please refer to the tooling overview and manuals on our website www.avdel-global.com.
 Pour les conditions de pose, merci de vous référer à la description de l'outil et aux manuels disponibles sur notre site Web.
 Angaben zur Verarbeitung entnehmen Sie bitte der Geräteübersicht und den Betriebsanleitungen auf unserer Website.
 Per informazioni sull'installazione preghiamo consultare i manuali e la panoramica degli attrezzi sul nostro sito web.
 Para ver información sobre máquinas de colocación, consulte nuestra página web, apartados visión general de máquinas y manuales.

English	Français	Deutsch	Italiano	Español
Dome head	Tête plate	Flachrundkopf	Testa tonda	Cabeza alomada
Low carbon steel*	Acier bas carbone*	Stahl*	Acciaio a basso tenore di carbonio*	Acero bajo en carbono*
Zinc plated	Revêtement zingué	Verzinkt	Zincato	Zincado
Clear trivalent passivated	Passivation claire trivalente	Klar chromatiert, Cr6-frei	Passivazione chiara trivalente	Pasivado claro trivalente

*: SAE 1008 / EN 10263-2 C8C (DIN 10263-2 C8C, Qst 34-3)

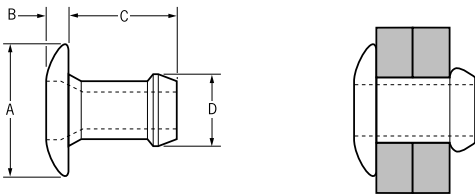

ø	[Diagram]		[Diagram]		A	B	C	D	[Diagram]	[Diagram]	Fasteners per pod / Nombre de rivets par chargeur / Niete pro Magazin / Rivetti per caricatore / Uds./carga	Part No/ref		
	nom.	min.	max.	min.									max.	± 0.4
3.2 (1/8")	0.64	1.91	3.26	3.34	6.2	0.99	3.86	3.16	1.1	1.8	59	01821-00403		
	1.14	2.42					4.37						58	01821-00404
	1.65	2.87					4.87						50	01821-00405
	2.15	3.43					5.39						48	01821-00406
	3.17	4.45					6.41						42	01821-00408
	4.19	5.47					7.42						37	01821-00410
	5.20	6.48					8.44						33	01821-00412
	6.22	7.50					9.45						29	01821-00414
	7.24	8.51					10.46						26	01821-00416
4.0 (5/32")	1.57	2.93	3.97	4.04	7.9	0.99	4.91	3.90	1.6	2.8	52	01821-00505		
	2.15	3.43					5.41						49	01821-00506
	2.66	3.94					5.92						44	01821-00507
	3.68	4.96					6.94						39	01821-00509
	4.69	5.97					7.95						34	01821-00511
	5.71	6.99					8.97						31	01821-00513
	6.73	8.00					9.98						26	01821-00515
	7.75	9.02					11.00						24	01821-00517

all dimensions in mm / en millimètres / alle Maße in mm / in millimetri / en milímetros

1) typical values / valeurs moyennes / typische Werte / Valori tipici / resistencias máximas recomendadas



An Acument™ Global Technologies Company

www.avdel-global.com





© 2007 Acument Intellectual Properties, LLC

Briv[®] is a trademark of Avdel UK Limited

04.2008, page 1/2

Data shown is subject to change without prior notice as a result of continuous product development and improvement policy.
 Your local Avdel representative is at your disposal should you need to confirm latest information.

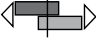
Briv® 1821

Ø					A	B	C	D			Fasteners per pod / Nombre de rivets par chargeur / Niete pro Magazin / Rivetti per caricatore / Uds./carga	Part No/ref
	min.	max.	min.	max.	± 0.4	max.	max.	max.	kN ¹⁾	kN ¹⁾		
4.8 (3/16")	1.65	3.30	4.85	4.93	9.4	1.17	5.39	4.79	2.2	3.7	46	01821-00606
	2.03	3.94					6.10				42	01821-00607
	3.68	5.21					7.37				35	01821-00609
	4.95	6.48					8.64				31	01821-00611
	6.22	7.75					9.91				27	01821-00613
	7.49	9.02					11.18				24	01821-00615
	8.76	10.29					12.45				22	01821-00617
6.0	2.66	3.94	5.94	6.02	11.3	1.35	6.93	5.93	2.5	4.2	37	01821-06007
	3.68	4.95					7.94				33	01821-06009
	4.70	5.96					8.96				29	01821-06011
	5.71	6.98					9.98				26	01821-06013
	6.73	7.99					10.99				24	01821-06015
	7.74	9.01					12.00				23	01821-06017

all dimensions in mm / en millimètres / alle Maße in mm / in millimetri / en milímetros

1) typical values / valeurs moyennes / typische Werte / Valori tipici / resistencias máximas recomendadas



An Acument™ Global Technologies Company

www.avdel-global.com

© 2007 Acument Intellectual Properties, LLC

Briv® is a trademark of Avdel UK Limited

04.2008, page 2/2

Data shown is subject to change without prior notice as a result of continuous product development and improvement policy.
Your local Avdel representative is at your disposal should you need to confirm latest information.