

Avsert® 1118



For installation information please refer to the tooling overview and manuals on our website www.avdel-global.com.
 Pour les conditions de pose, merci de vous référer à la description de l'outil et aux manuels disponibles sur notre site Web.
 Angaben zur Verarbeitung entnehmen Sie bitte der Geräteübersicht und den Betriebsanleitungen auf unserer Website.
 Per informazioni sull'installazione preghiamo consultare i manuali e la panoramica degli attrezzi sul nostro sito web.
 Para ver información sobre máquinas de colocación, consulte nuestra página web, apartados visión general de máquinas y manuales.

English	Français	Deutsch	Italiano	Español
Long spigot	Pion long	Langer Schaft	Piedino lungo	Espiga larga
Brass*	Laiton*	Kupfer-Zink Legierung*	Ottone*	Latón*
Tin plated**	Étamé**	verzinkt**	Stagnato**	Estañado**

*: CuZn38Pb1.5 (ROHS conform)

**: ROHS conform; Avdel recommends tin plated parts are installed within 24 months from the date they were produced / Avdel conseille d'utiliser les pièces en laiton étamé sous un délai de 24 mois après la date de production / Avdel empfiehlt, verzinnte Niete innerhalb 24 Monaten nach Produktionsdatum zu verarbeiten / Avdel raccomanda di utilizzare i prodotti stagnati entro 24 mesi a decorrere dalla data di fabbricazione / Avdel recomienda utilizar sus piezas estañadas antes de 24 meses desde la fecha de su fabricación.

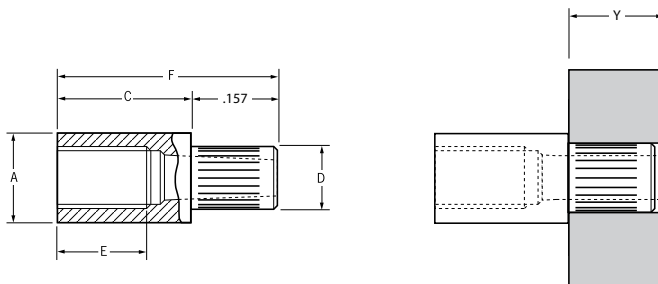

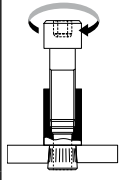
Ø	Y		Drill Bit		A	C ± .004	D	E	F ± .008	 lbf in max. ¹⁾	Fasteners per pod/ Nombre de rivets par chargeur/ Niete pro Magazin/ Rivetti per carica- tore / Uds./carga ± 1	Part No/ref
	nom.	min.	max.	min.								
M2.5 x 0.45	.032	.094	.106	.110	.159	.217	.106	.134	.374	8.50	30	01118-06555
						.236		.153	.393		29	01118-06560
						.276		.193	.433		26	01118-06570
						.315		.232	.472		24	01118-06580
						.354		.232	.512		22	01118-06590
M3 x 0.5	.032	.094	.130	.134	.191	.217	.129	.134	.374	13.45	30	01118-07055
						.236		.153	.393		29	01118-07060
						.276		.193	.433		26	01118-07070
						.315		.232	.472		24	01118-07080
						.354		.232	.512		22	01118-07090

all dimensions in inches / en pouces / alle Maße in Zoll / in pollici / en pulgadas

1) As tested in .059" thick glass fibre reinforced board to specification NEMA-L11-1971 Type FR4.

Testé dans circuit imprimé fibre / époxy 15/10 selon NEMA-L11-1971 type FR4.

Getestet in .059" starker glasfaserverstärkter Leiterplatte nach Spezifikation NEMA-L11-1971 Typ FR4.

Testato in un circuito rinforzato con fibra di vetro di .059" come da specifica NEMA-L11-1971 tipo FR4.

Testado en una tarjeta reforzada con fibra de vidrio de .059".



An Acument™ Global Technologies Company

www.avdel-global.com

© 2007 Acument Intellectual Properties, LLC

Avsert® is a trademark of Avdel UK Limited

05c.2007

Data shown is subject to change without prior notice as a result of continuous product development and improvement policy.
 Your local Avdel representative is at your disposal should you need to confirm latest information.