

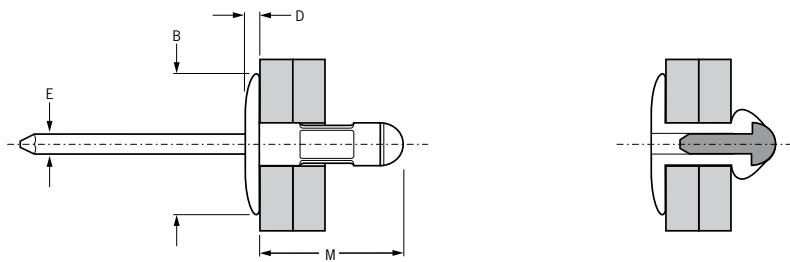

| English | Français | Deutsch | Italiano | Español |
|---|--|--|--|---|
| Large Flange | Tête large | Flachrundkopf extragroß | Testa larga | Cabeza ancha |
| Body: Aluminium alloy* (2.5 % Mg) Natural | Corps: Alliage d'aluminium* (2.5% Mg) Brut | Hülse: Aluminium* (2.5 % Mg) Blank | Corpo: Lega di alluminio* (2.5% Mg) Nessuna finitura | Cuerpo: Aluminio* (2.5% Mg) Natural |
| Stem: Stainless steel** Natural | Tige: Inox** Brut | Dorn: Edelstahl** Blank | Gambo: Acciaio inox** Nessuna finitura | Vástago: Acero inoxidable** Natural |

*: AA 5052, DIN 1725, AlMg2.5, Werkstoff 3.3523

** : BS3111, 321S31, AISI 321, Werkstoff 1.4541



| ø | | | | | M | B | D | E | lbf ⁽¹⁾ | lbf ⁽¹⁾ | Part No/ref |
|-------------------|------|------|------|------|-------|------|------|------|------------------------|------------------------|-------------|
| | nom. | min. | max. | min. | | | | | | | |
| 3/16" (4.8 mm) | .062 | .250 | .193 | .199 | .534 | .637 | .084 | .112 | 315 | 450 | 01643-00613 |
| | .250 | .500 | | | .774 | | | | 270 | | 01643-00621 |
| | .500 | .781 | | | 1.086 | | | | 292 | | 01643-00631 |

all dimensions in inches / en pouces / alle Maße in Zoll / in pollici / en pulgadas

1) typical values / valeurs moyennes / typische Werte / Valori tipici / resistencias máximas recomendadas