

# Avdelok® 2691



For installation information please refer to the tooling overview and manuals on our website [www.avdel-global.com](http://www.avdel-global.com).  
 Pour les conditions de pose, merci de vous référer à la description de l'outil et aux manuels disponibles sur notre site Web.  
 Angaben zur Verarbeitung entnehmen Sie bitte der Geräteübersicht und den Betriebsanleitungen auf unserer Website.  
 Per informazioni sull'installazione preghiamo consultare i manuali e la panoramica degli attrezzi sul nostro sito web.  
 Para ver información sobre máquinas de colocación, consulte nuestra página web, apartados visión general de máquinas y manuales.

| English  | Français  | Deutsch  | Italiano  | Español  |
|--|---|--|---|--|
| Brazier head   | Tête plate  | Flachrundkopf  | Testa tonda   | Cabeza alomada   |
| Pin: Stainless steel*<br>natural                                       | Tige: Inox*<br>Brut   | Bolzen: Edelstahl*<br>Blank  | Bullone: Acciaio inox *<br>Nessuna finitura                             | Vástago: Acero inoxidable*<br>Natural                              |
| Collar: Stainless steel**<br>Zinc plated<br>Clear trivalent passivated | Bague: Inox**<br>Revêtement zingué<br>Passivation claire trivalente | Schließring: Edelstahl**<br>Verzinkt<br>Klar chromatiert, Cr6-frei | Collare: Acciaio inox**<br>Zincato<br>Passivazione chiara<br>trivalente | Collar: Acero inoxidable**<br>Zincado<br>Pasivado claro trivalente |

\*: AISI 304Cu, EN 10263-5, X3CrNiCu18-9-4 \*\*: AISI 430, EN 10263-5 X6Cr17

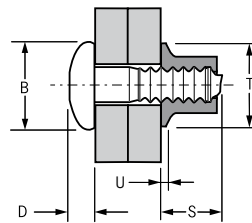
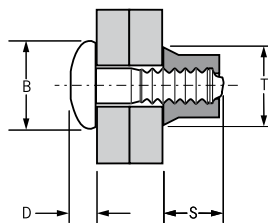
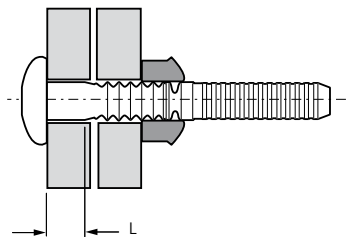

Full Collar  
Schließring Standard  
Bague Standard  
Collare Standard  
Collar Estándar

Flanged Collar  
Schließring mit Bund  
Bague à embase  
Collare flangiato  
Collar con Ala

| ø              | w. Full Collar |       | L           | B    | D    | Part No/ref       | Part No/ref |           | Part No/ref                  |           |                         |      |
|----------------|----------------|-------|-------------|------|------|-------------------|-------------|-----------|------------------------------|-----------|-------------------------|------|
|                | min.           | max.  |             |      |      |                   | Full Collar |           | Flanged Collar <sup>2)</sup> |           |                         |      |
| nom.           |                |       | nom.        | max. | max. | Pin <sup>1)</sup> | S<br>max.   | T<br>max. | S<br>max.                    | T<br>max. | U <sup>2)</sup><br>nom. |      |
| 4.8<br>(3/16") | 1.57           | 4.75  | 1.57        | 10.0 | 3.4  | 02691-00602       | 02605-70600 | 9.4       | 8.0                          | 10.2      | 9.9                     | 0.76 |
|                | 3.18           | 6.35  | 3.18        |      |      | 02691-00603       |             |           |                              |           |                         |      |
|                | 4.75           | 7.92  | 4.75        |      |      | 02691-00604       |             |           |                              |           |                         |      |
|                | 6.35           | 9.53  | 6.35        |      |      | 02691-00605       |             |           |                              |           |                         |      |
|                | 7.92           | 11.10 | 7.92        |      |      | 02691-00606       |             |           |                              |           |                         |      |
|                | 9.53           | 12.70 | 9.53        |      |      | 02691-00607       |             |           |                              |           |                         |      |
|                | 11.10          | 14.27 | 11.10       |      |      | 02691-00608       |             |           |                              |           |                         |      |
|                | 12.70          | 15.88 | 12.70       |      |      | 02691-00609       |             |           |                              |           |                         |      |
|                | 14.27          | 17.45 | 14.27       |      |      | 02691-00610       |             |           |                              |           |                         |      |
|                | 15.88          | 19.05 | 15.88       |      |      | 02691-00611       |             |           |                              |           |                         |      |
|                | 17.45          | 20.62 | 17.45       |      |      | 02691-00612       |             |           |                              |           |                         |      |
|                | 19.05          | 22.23 | 19.05       |      |      | 02691-00613       |             |           |                              |           |                         |      |
|                | 20.62          | 23.80 | 20.62       |      |      | 02691-00614       |             |           |                              |           |                         |      |
| 22.23          | 25.40          | 22.23 | 02691-00615 |      |      |                   |             |           |                              |           |                         |      |

all dimensions in mm / en millimètre / alle Maße in mm / in millimetri / en milímetros

1) & 2) see last page / voir page 3 / siehe letzte Seite / vedi pagina 3 / ver Pág. 3



An Acument™ Global Technologies Company

[www.avdel-global.com](http://www.avdel-global.com)



© 2007 Acument Intellectual Properties, LLC

Avdelok® is a trademark of Avdel UK Limited

04.2008, page 1/3

Data shown is subject to change without prior notice as a result of continuous product development and improvement policy.  
 Your local Avdel representative is at your disposal should you need to confirm latest information.

# Avdelok® 2691

| ø              |  |       |  | L     | B    | D    | Part No/ref       | Part No/ref |        | Part No/ref                  |                                   |                      |
|----------------|---|-------|---|-------|------|------|-------------------|-------------|--------|------------------------------|-----------------------------------|----------------------|
|                | w. Full Collar  |       |   |       |      |      |                   | Full Collar |        | Flanged Collar <sup>2)</sup> |                                   |                      |
| nom.           | min.  | max.  |   | nom.  | max. | max. | Pin <sup>1)</sup> | S max.      | T max. | S max.                       | T max.                            | U <sup>2)</sup> nom. |
| 4.8<br>(3/16") | 23.80   | 26.97 | 5.0   | 23.80 | 10.0 | 3.4  | 02691-00616       | 02605-70600 | 9.4    | 8.0                          | 02648-70600<br>10.2   9.9   0.76  |                      |
|                | 25.40   | 28.58 |   | 25.40 |      |      | 02691-00617       |             |        |                              |                                   |                      |
|                | 26.97   | 30.15 |   | 26.97 |      |      | 02691-00618       |             |        |                              |                                   |                      |
|                | 28.58   | 31.75 |   | 28.58 |      |      | 02691-00619       |             |        |                              |                                   |                      |
|                | 30.15   | 33.32 |   | 30.15 |      |      | 02691-00620       |             |        |                              |                                   |                      |
| 6.4<br>(1/4")  | 1.57  | 4.75  | 6.6   | 1.57  | 13.4 | 4.1  | 02691-00802       | 02605-70800 | 12.2   | 10.6                         | 02648-70800<br>13.2   13.1   0.94 |                      |
|                | 3.18  | 6.35  |   | 3.18  |      |      | 02691-00803       |             |        |                              |                                   |                      |
|                | 4.75  | 7.92  |   | 4.75  |      |      | 02691-00804       |             |        |                              |                                   |                      |
|                | 6.35  | 9.53  |   | 6.35  |      |      | 02691-00805       |             |        |                              |                                   |                      |
|                | 7.92  | 11.10 |   | 7.92  |      |      | 02691-00806       |             |        |                              |                                   |                      |
|                | 9.53  | 12.70 |   | 9.53  |      |      | 02691-00807       |             |        |                              |                                   |                      |
|                | 11.10   | 14.27 |   | 11.10 |      |      | 02691-00808       |             |        |                              |                                   |                      |
|                | 12.70   | 15.88 |   | 12.70 |      |      | 02691-00809       |             |        |                              |                                   |                      |
|                | 14.27   | 17.45 |   | 14.27 |      |      | 02691-00810       |             |        |                              |                                   |                      |
|                | 15.88   | 19.05 |   | 15.88 |      |      | 02691-00811       |             |        |                              |                                   |                      |
|                | 17.45   | 20.62 |   | 17.45 |      |      | 02691-00812       |             |        |                              |                                   |                      |
|                | 19.05   | 22.23 |   | 19.05 |      |      | 02691-00813       |             |        |                              |                                   |                      |
|                | 20.62   | 23.80 |   | 20.62 |      |      | 02691-00814       |             |        |                              |                                   |                      |
|                | 22.23   | 25.40 |   | 22.23 |      |      | 02691-00815       |             |        |                              |                                   |                      |
|                | 23.80   | 26.97 |   | 23.80 |      |      | 02691-00816       |             |        |                              |                                   |                      |
| 26.97          | 30.15   | 26.97 | 02691-00818   |       |      |      |                   |             |        |                              |                                   |                      |
| 30.15          | 33.32   | 30.15 | 02691-00820   |       |      |      |                   |             |        |                              |                                   |                      |
| 8.0<br>(5/16") | 3.18  | 9.53  | 8.2   | 3.18  | 16.7 | 5.5  | 02691-01004       | 02605-71000 | 15.5   | 13.3                         | N/A                               |                      |
|                | 6.35  | 12.70 |   | 6.35  |      |      | 02691-01006       |             |        |                              |                                   |                      |
|                | 9.53  | 15.88 |   | 9.53  |      |      | 02691-01008       |             |        |                              |                                   |                      |
|                | 12.70   | 19.05 |   | 12.70 |      |      | 02691-01010       |             |        |                              |                                   |                      |
|                | 15.88   | 22.23 |   | 15.88 |      |      | 02691-01012       |             |        |                              |                                   |                      |
|                | 19.05   | 25.40 |   | 19.05 |      |      | 02691-01014       |             |        |                              |                                   |                      |
|                | 22.23   | 28.58 |   | 22.23 |      |      | 02691-01016       |             |        |                              |                                   |                      |
|                | 25.40   | 31.75 |   | 25.40 |      |      | 02691-01018       |             |        |                              |                                   |                      |
|                | 28.58   | 34.93 |   | 28.58 |      |      | 02691-01020       |             |        |                              |                                   |                      |
|                | 31.75   | 38.10 |   | 31.75 |      |      | 02691-01022       |             |        |                              |                                   |                      |
|                | 34.93   | 41.28 |   | 34.93 |      |      | 02691-01024       |             |        |                              |                                   |                      |
|                | 38.10   | 44.45 |   | 38.10 |      |      | 02691-01026       |             |        |                              |                                   |                      |
|                | 41.28   | 47.63 |   | 41.28 |      |      | 02691-01028       |             |        |                              |                                   |                      |
|                | 44.45   | 50.80 |   | 44.45 |      |      | 02691-01030       |             |        |                              |                                   |                      |
|                | 47.63   | 53.98 |   | 47.63 |      |      | 02691-01032       |             |        |                              |                                   |                      |

all dimensions in mm / en millimètre / alle Maße in mm / in millimetri / en milímetros

1) & 2) see last page / voir page 3 / siehe letzte Seite / vedi pagina 3 / ver Pág. 3



An Acument™ Global Technologies Company

www.avdel-global.com



© 2007 Acument Intellectual Properties, LLC

Avdelok® is a trademark of Avdel UK Limited

04.2008, page 2/3

Data shown is subject to change without prior notice as a result of continuous product development and improvement policy.  
Your local Avdel representative is at your disposal should you need to confirm latest information.

# Avdelok® 2691

| ø             |  |       |  | L     | B    | D    | Part No/ref       | Part No/ref |        | Part No/ref                  |        |                      |
|---------------|---|-------|---|-------|------|------|-------------------|-------------|--------|------------------------------|--------|----------------------|
|               | w. Full Collar  |       |   |       |      |      |                   | Full Collar |        | Flanged Collar <sup>2)</sup> |        |                      |
| nom.          | min.  | max.  |   | nom.  | max. | max. | Pin <sup>1)</sup> | S max.      | T max. | S max.                       | T max. | U <sup>2)</sup> nom. |
| 9.6<br>(3/8") | 3.18  | 9.53  | 9.8   | 3.18  | 20.0 | 6.7  | 02691-01204       | 02605-71200 | 18.6   | 15.5                         | N/A    |                      |
|               | 6.35  | 12.70 |   | 6.35  |      |      | 02691-01206       |             |        |                              |        |                      |
|               | 9.53  | 15.88 |   | 9.53  |      |      | 02691-01208       |             |        |                              |        |                      |
|               | 12.70   | 19.05 |   | 12.70 |      |      | 02691-01210       |             |        |                              |        |                      |
|               | 15.88   | 22.23 |   | 15.88 |      |      | 02691-01212       |             |        |                              |        |                      |
|               | 19.05   | 25.40 |   | 19.05 |      |      | 02691-01214       |             |        |                              |        |                      |
|               | 22.23   | 28.58 |   | 22.23 |      |      | 02691-01216       |             |        |                              |        |                      |
|               | 25.40   | 31.75 |   | 25.40 |      |      | 02691-01218       |             |        |                              |        |                      |
|               | 28.58   | 34.93 |   | 28.58 |      |      | 02691-01220       |             |        |                              |        |                      |
|               | 31.75   | 38.10 |   | 31.75 |      |      | 02691-01222       |             |        |                              |        |                      |
|               | 34.93   | 41.28 |   | 34.93 |      |      | 02691-01224       |             |        |                              |        |                      |
|               | 38.10   | 44.45 |   | 38.10 |      |      | 02691-01226       |             |        |                              |        |                      |
|               | 41.28   | 47.63 |   | 41.28 |      |      | 02691-01228       |             |        |                              |        |                      |
|               | 44.45   | 50.80 |   | 44.45 |      |      | 02691-01230       |             |        |                              |        |                      |
| 47.63         | 53.98   | 47.63 | 02691-01232   |       |      |      |                   |             |        |                              |        |                      |

all dimensions in mm / en millimètre / alle Maße in mm / in millimetri / en milímetros

1) Different grip range pins with different numbers of grooves are available

Tiges avec autres plages de serrage et différent nombre de cannelures sont disponible

Bolzen mit anderem Klemmbereich und anderer Anzahl von Rillen sind verfügbar

Sono disponibili bulloni con spessori serrabili differenti con diverso numero di scanalature

Disponibles pernos con diferente número de anillos según el espesor a remachar



2) Flanged collars are used in applications where the hole on the collar side of the application is oversize or is slotted for alignment purposes. To determine what length of pin is required, add dimension U to the thickness of material being fastened.

Avec une bague à embase, la plage de serrage est diminuée de la valeur de la cote U.

Schließringe mit Bund werden in Anwendungen benötigt, wo das Bohrloch auf der Schließringseite übergroß oder länglich ist. Um den richtigen Bolzen zu bestimmen, addieren Sie das Maß U zu der zu verbindenden Materialstärke hinzu.

Utilizzando i collari flangiati la dimensione „U“ deve essere aggiunta allo spessore da serrare per determinare il tipo di bullone adatto.

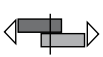
Utilizar collar con ala cuando en la aplicación el taladro está sobredimensionado o es ranurado. Para calcular la referencia de perno necesaria añadir la cota U al espesor de la aplicación.

| ø           |  |  |
|-------------|---|---|
| nom.        | kN <sup>3)</sup>  | kN <sup>3)</sup>  |
| 4.8 (3/16") | 7.79  | 9.26  |
| 6.4 (1/4")  | 14.55   | 17.71   |
| 8.0 (5/16") | 22.24   | 29.80   |
| 9.6 (3/8")  | 31.58   | 37.81   |

3) These figures represent minimum fastener shear and tensile strength values with the use of a full collar.

Cette valeurs représentent minimum résistances au cisaillement et à la traction avec l'usage d'une bague standard.

Diese Werte repräsentieren Minimum Scher- und Zugfestigkeiten der Verbindung unter Verwendung von Standard-Schließringen.

I dati indicati in tabella sono minimi e si riferiscono a bulloni installati con collari Standard.

La figura representa los valores mínimos de resistencia a la cortadura y tracción cuando se utiliza collar estándar.



An Acument™ Global Technologies Company

www.avdel-global.com

© 2007 Acument Intellectual Properties, LLC

Avdelok® is a trademark of Avdel UK Limited

04.2008, page 3/3

Data shown is subject to change without prior notice as a result of continuous product development and improvement policy.  
Your local Avdel representative is at your disposal should you need to confirm latest information.