

# Avdelmate® BSLMS

For installation information please refer to the tooling overview and manuals on our website [www.avdel-global.com](http://www.avdel-global.com).  
 Pour les conditions de pose, merci de vous référer à la description de l'outil et aux manuels disponibles sur notre site Web.  
 Angaben zur Verarbeitung entnehmen Sie bitte der Geräteübersicht und den Betriebsanleitungen auf unserer Website.  
 Per informazioni sull'installazione preghiamo consultare i manuali e la panoramica degli attrezzi sul nostro sito web.  
 Para ver información sobre máquinas de colocación, consulte nuestra página web, apartados visión general de máquinas y manuales.

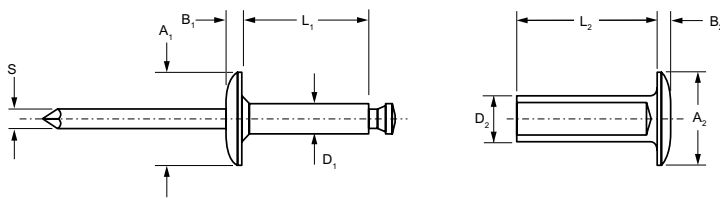

| English  | Français  | Deutsch   | Italiano   | Español   |
|--|---|---|--|---|
| Body: Aluminium<br>Clear alodine                 | Corps: Aluminium<br>Passivation claire                  | Hülse: Aluminium<br>Klar chromatiert                          | Corpo: Alluminio<br>Passivato chiara                     | Cuerpo: Aluminio<br>Pasivado claro                |
| Mandrel: Steel<br>Zinc plated                    | Tige: Acier<br>Revêtement zingué                        | Dorn: Stahl<br>Verzinkt                                       | Gambo: Acciaio<br>Zincati                                | Vástago: Acero<br>Zincado                         |
| Tubular Component:<br>Aluminium<br>Clear alodine | Composant tubulaire:<br>Aluminium<br>Passivation claire | Röhrenförmiges Gegen-<br>stück: Aluminium<br>Klar chromatiert | Componente tubulare:<br>Alluminio<br>Passivazione chiara | Componente tubular:<br>Aluminio<br>Pasivado claro |



| ø<br>nom.      | [Material/Finish] |       | D <sub>1</sub> | L <sub>1</sub><br>max. | A <sub>1</sub> | B <sub>1</sub> | S    | D <sub>2</sub> | L <sub>2</sub><br>max. | A <sub>2</sub> | B <sub>2</sub> | [Strength] | Part No/ref   |
|----------------|-------------------|-------|----------------|------------------------|----------------|----------------|------|----------------|------------------------|----------------|----------------|------------|---------------|
|                | min.              | max.  |                |                        |                |                |      |                |                        |                |                |            |               |
| 4.8<br>(3/16") | 15.88             | 19.05 | 6.4            | 3.18                   | 13.34          | 9.53           | 1.50 | 1.93           | 4.78                   | 9.53           | 1.45           | N/A        | BSLMS-06BP-12 |
|                | 17.48             | 22.23 |                |                        |                |                |      |                |                        |                |                |            | BSLMS-06BP-14 |
|                | 22.23             | 27.00 |                |                        |                |                |      |                |                        |                |                |            | BSLMS-06BP-17 |
|                | 27.00             | 31.75 |                |                        |                |                |      |                |                        |                |                |            | BSLMS-06BP-20 |
|                | 31.75             | 36.53 |                |                        |                |                |      |                |                        |                |                |            | BSLMS-06BP-23 |
|                | 36.53             | 41.28 |                |                        |                |                |      |                |                        |                |                |            | BSLMS-06BP-26 |
|                | 41.28             | 46.05 |                |                        |                |                |      |                |                        |                |                |            | BSLMS-06BP-29 |
|                | 46.05             | 50.80 |                |                        |                |                |      |                |                        |                |                |            | BSLMS-06BP-32 |
|                | 50.80             | 55.58 |                |                        |                |                |      |                |                        |                |                |            | BSLMS-06BP-35 |
|                | 55.58             | 60.33 |                |                        |                |                |      |                |                        |                |                |            | BSLMS-06BP-38 |
| 6.4<br>(1/4")  | 15.88             | 19.05 | 7.9            | 4.75                   | 11.23          | 15.88          | 2.41 | 2.90           | 6.35                   | 15.88          | 2.41           | 2.0        | BSLMS-08BP-12 |
|                | 19.05             | 22.23 |                |                        | BSLMS-08BP-14  |                |      |                |                        |                |                |            |               |
|                | 22.23             | 28.58 |                |                        | BSLMS-08BP-18  |                |      |                |                        |                |                |            |               |
|                | 28.58             | 34.93 |                |                        | BSLMS-08BP-22  |                |      |                |                        |                |                |            |               |
|                | 34.93             | 41.28 |                |                        | BSLMS-08BP-26  |                |      |                |                        |                |                |            |               |
|                | 41.28             | 47.63 |                |                        | BSLMS-08BP-30  |                |      |                |                        |                |                |            |               |
|                | 47.63             | 53.98 |                |                        | BSLMS-08BP-34  |                |      |                |                        |                |                |            |               |
|                | 53.98             | 60.33 |                |                        | BSLMS-08BP-38  |                |      |                |                        |                |                |            |               |
|                | 60.33             | 66.68 |                |                        | BSLMS-08BP-42  |                |      |                |                        |                |                |            |               |
|                | 66.68             | 73.03 |                |                        | BSLMS-08BP-46  |                |      |                |                        |                |                |            |               |
|                | 73.03             | 79.38 |                |                        | BSLMS-08BP-50  |                |      |                |                        |                |                |            |               |
|                | 79.38             | 85.73 |                |                        | BSLMS-08BP-54  |                |      |                |                        |                |                |            |               |
|                | 85.73             | 92.08 |                |                        | BSLMS-08BP-58  |                |      |                |                        |                |                |            |               |
|                | 92.08             | 98.43 |                |                        | BSLMS-08BP-62  |                |      |                |                        |                |                |            |               |

all dimensions in mm / en millimètres / alle Maße in mm / in millimetri / en milímetros

1) typical values / valeurs moyennes / typische Werte / Valori tipici / resistencias máximas recomendadas



An Acument™ Global Technologies Company

[www.avdel-global.com](http://www.avdel-global.com)

© 2007 Acument Intellectual Properties, LLC

Avdelmate® is a trademark of Avdel UK Limited

07b.2007

Data shown is subject to change without prior notice as a result of continuous product development and improvement policy.  
 Your local Avdel representative is at your disposal should you need to confirm latest information.