

# Avdelmate® BSLMS

For installation information please refer to the tooling overview and manuals on our website [www.avdel-global.com](http://www.avdel-global.com).  
 Pour les conditions de pose, merci de vous référer à la description de l'outil et aux manuels disponibles sur notre site Web.  
 Angaben zur Verarbeitung entnehmen Sie bitte der Geräteübersicht und den Betriebsanleitungen auf unserer Website.  
 Per informazioni sull'installazione preghiamo consultare i manuali e la panoramica degli attrezzi sul nostro sito web.  
 Para ver información sobre máquinas de colocación, consulte nuestra página web, apartados visión general de máquinas y manuales.

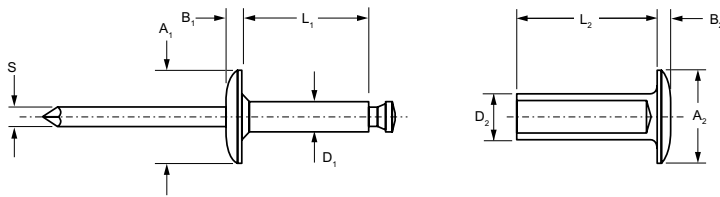

English	Français	Deutsch	Italiano	Español
Body: Aluminium Clear alodine	Corps: Aluminium Passivation claire	Hülse: Aluminium Klar chromatiert	Corpo: Alluminio Passivato chiara	Cuerpo: Aluminio Pasivado claro
Mandrel: Steel Zinc plated	Tige: Acier Revêtement zingué	Dorn: Stahl Verzinkt	Gambo: Acciaio Zincati	Vástago: Acero Zincado
Tubular Component: Aluminium Clear alodine	Composant tubulaire: Aluminium Passivation claire	Röhrenförmiges Gegen- stück: Aluminium Klar chromatiert	Componente tubulare: Alluminio Passivazione chiara	Componente tubular: Aluminio Pasivado claro



ø nom.	Material		D <sub>1</sub>	L <sub>1</sub> max.	A <sub>1</sub>	B <sub>1</sub>	S	D <sub>2</sub>	L <sub>2</sub> max.	A <sub>2</sub>	B <sub>2</sub>	Tightening Torque lbf <sup>1)</sup>	Part No/ref
	min.	max.											
3/16" (4.8 mm)	.625	.750	.250	.125	.525	.375	.059	.076	.188	.375	.057	N/A	BSLMS-06BP-12
	.688	.875											BSLMS-06BP-14
	.875	1.063											BSLMS-06BP-17
	1.063	1.250											BSLMS-06BP-20
	1.250	1.438											BSLMS-06BP-23
	1.438	1.625											BSLMS-06BP-26
	1.625	1.813											BSLMS-06BP-29
	1.813	2.000											BSLMS-06BP-32
	2.000	2.188											BSLMS-06BP-35
	2.188	2.375											BSLMS-06BP-38
1/4" (6.4 mm)	.625	.750	.312	.187	.442	.625	.095	.114	.250	.625	.095	450	BSLMS-08BP-12
	.750	.875											BSLMS-08BP-14
	.875	1.125											BSLMS-08BP-18
	1.125	1.375											BSLMS-08BP-22
	1.375	1.625											BSLMS-08BP-26
	1.625	1.875											BSLMS-08BP-30
	1.875	2.125		BSLMS-08BP-34									
	2.125	2.375		BSLMS-08BP-38									
	2.375	2.625		BSLMS-08BP-42									
	2.625	2.875		BSLMS-08BP-46									
	2.875	3.125		BSLMS-08BP-50									
	3.125	3.375		BSLMS-08BP-54									
	3.375	3.625		BSLMS-08BP-58									
	3.625	3.875		BSLMS-08BP-62									

all dimensions in inches / en pouces / alle Maße in Zoll / in pollici / en pulgadas

1) typical values / valeurs moyennes / typische Werte / Valori tipici / resistencias máximas recomendadas



An Acument™ Global Technologies Company

[www.avdel-global.com](http://www.avdel-global.com)

© 2007 Acument Intellectual Properties, LLC

Avdelmate® is a trademark of Avdel UK Limited

07b.2007

Data shown is subject to change without prior notice as a result of continuous product development and improvement policy.  
 Your local Avdel representative is at your disposal should you need to confirm latest information.