

Avdelmate® BALMS

For installation information please refer to the tooling overview and manuals on our website www.avdel-global.com.
 Pour les conditions de pose, merci de vous référer à la description de l'outil et aux manuels disponibles sur notre site Web.
 Angaben zur Verarbeitung entnehmen Sie bitte der Geräteübersicht und den Betriebsanleitungen auf unserer Website.
 Per informazioni sull'installazione preghiamo consultare i manuali e la panoramica degli attrezzi sul nostro sito web.
 Para ver información sobre máquinas de colocación, consulte nuestra página web, apartados visión general de máquinas y manuales.

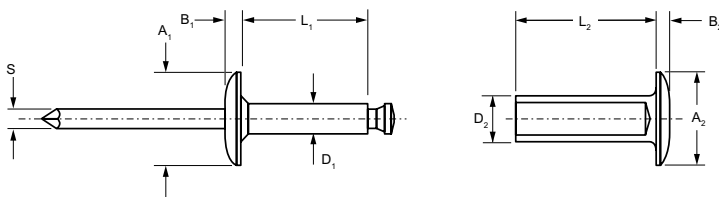

English	Français	Deutsch	Italiano	Español
Body: Aluminium Clear alodine	Corps: Aluminium Passivation claire	Hülse: Aluminium Klar chromatiert	Corpo: Alluminio Passivato chiara	Cuerpo: Aluminio Pasivado claro
Mandrel: Aluminium Natural	Tige: Aluminium Brut	Dorn: Aluminium Blank	Gambo: Alluminio Nessuna finitura	Vástago: Aluminio Natural
Tubular Component: Aluminium Clear alodine	Composant tubulaire: Aluminium Passivation claire	Röhrenförmiges Gegen- stück: Aluminium Klar chromatiert	Componente tubulare: Alluminio Passivazione chiara	Componente tubular: Aluminio Pasivado claro



ø nom.	[Cross-section diagram]		D ₁	L ₁ max.	A ₁	B ₁	S	D ₂	L ₂ max.	A ₂	B ₂	[Thread diagram]	kN ¹⁾	Part No/ref
	min.	max.												
4.8 (3/16")	15.88	19.05	6.4	3.18	13.34	9.53	1.50	1.93	4.78	9.53	1.45	N/A		BALMS-06BP-12
	17.48	22.23												BALMS-06BP-14
	22.23	27.00												BALMS-06BP-17
	27.00	31.75												BALMS-06BP-20
	31.75	36.53												BALMS-06BP-23
	36.53	41.28												BALMS-06BP-26
	41.28	46.05												BALMS-06BP-29
	46.05	50.80												BALMS-06BP-32
	50.80	55.58												BALMS-06BP-35
	55.58	60.33												BALMS-06BP-38
6.4 (1/4")	15.88	19.05	7.9	4.75	11.23	15.88	2.41	2.90	6.35	15.88	2.41	1.1		BALMS-08BP-12
	19.05	22.23			BALMS-08BP-14									
	22.23	28.58			BALMS-08BP-18									
	28.58	34.93			BALMS-08BP-22									
	34.93	41.28			BALMS-08BP-26									
	41.28	47.63			BALMS-08BP-30									
	47.63	53.98			BALMS-08BP-34									
	53.98	60.33			BALMS-08BP-38									
	60.33	66.68			BALMS-08BP-42									
	66.68	73.03			BALMS-08BP-46									
	73.03	79.38			BALMS-08BP-50									
	79.38	85.73			BALMS-08BP-54									
	85.73	92.08			BALMS-08BP-58									
	92.08	98.43			BALMS-08BP-62									

all dimensions in mm / en millimètres / alle Maße in mm / in millimetri / en milímetros

1) typical values / valeurs moyennes / typische Werte / Valori tipici / resistencias máximas recomendadas



An Acument™ Global Technologies Company

www.avdel-global.com

© 2007 Acument Intellectual Properties, LLC

Avdelmate® is a trademark of Avdel UK Limited

07b.2007

Data shown is subject to change without prior notice as a result of continuous product development and improvement policy.
 Your local Avdel representative is at your disposal should you need to confirm latest information.