

Avdelmate® BALMS

For installation information please refer to the tooling overview and manuals on our website www.avdel-global.com.
 Pour les conditions de pose, merci de vous référer à la description de l'outil et aux manuels disponibles sur notre site Web.
 Angaben zur Verarbeitung entnehmen Sie bitte der Geräteübersicht und den Betriebsanleitungen auf unserer Website.
 Per informazioni sull'installazione preghiamo consultare i manuali e la panoramica degli attrezzi sul nostro sito web.
 Para ver información sobre máquinas de colocación, consulte nuestra página web, apartados visión general de máquinas y manuales.

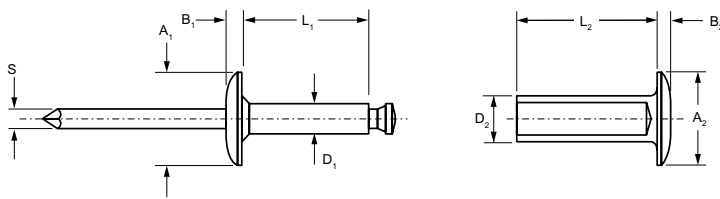

English	Français	Deutsch	Italiano	Español
Body: Aluminium Clear alodine	Corps: Aluminium Passivation claire	Hülse: Aluminium Klar chromatiert	Corpo: Alluminio Passivato chiara	Cuerpo: Aluminio Pasivado claro
Mandrel: Aluminium Natural	Tige: Aluminium Brut	Dorn: Aluminium Blank	Gambo: Alluminio Nessuna finitura	Vástago: Aluminio Natural
Tubular Component: Aluminium Clear alodine	Composant tubulaire: Aluminium Passivation claire	Röhrenförmiges Gegen- stück: Aluminium Klar chromatiert	Componente tubulare: Alluminio Passivazione chiara	Componente tubular: Aluminio Pasivado claro



ø nom.	[Material Legend]		D ₁	L ₁ max.	A ₁	B ₁	S	D ₂	L ₂ max.	A ₂	B ₂	[Thread Legend]	Part No/ref	
	min.	max.												
3/16" (4.8 mm)	.625	.750	.250	.125	.525	.375	.059	.076	.188	.585	.375	.057	N/A	BALMS-06BP-12
	.688	.875								.647				BALMS-06BP-14
	.875	1.063								.825				BALMS-06BP-17
	1.063	1.250								1.012				BALMS-06BP-20
	1.250	1.438								1.200				BALMS-06BP-23
	1.438	1.625								1.387				BALMS-06BP-26
	1.625	1.813								1.575				BALMS-06BP-29
	1.813	2.000								1.762				BALMS-06BP-32
	2.000	2.188								1.950				BALMS-06BP-35
	2.188	2.375								2.137				BALMS-06BP-38
1/4" (6.4 mm)	.625	.750	.312	.187	.442	.625	.095	.114	.250	.580	.625	.095	250	BALMS-08BP-12
	.750	.875								.695				BALMS-08BP-14
	.875	1.125								.820				BALMS-08BP-18
	1.125	1.375								1.070				BALMS-08BP-22
	1.375	1.625			1.320					BALMS-08BP-26				
	1.625	1.875			1.570					BALMS-08BP-30				
	1.875	2.125			1.820					BALMS-08BP-34				
	2.125	2.375			2.070					BALMS-08BP-38				
	2.375	2.625			2.320					BALMS-08BP-42				
	2.625	2.875			2.570					BALMS-08BP-46				
	2.875	3.125			2.820					BALMS-08BP-50				
	3.125	3.375			3.070					BALMS-08BP-54				
	3.375	3.625			3.320					BALMS-08BP-58				
	3.625	3.875			3.570					BALMS-08BP-62				

all dimensions in inches / en pouces / alle Maße in Zoll / in pollici / en pulgadas

1) typical values / valeurs moyennes / typische Werte / Valori tipici / resistencias máximas recomendadas



An Acument™ Global Technologies Company

www.avdel-global.com

© 2007 Acument Intellectual Properties, LLC

Avdelmate® is a trademark of Avdel UK Limited

07b.2007

Data shown is subject to change without prior notice as a result of continuous product development and improvement policy.
 Your local Avdel representative is at your disposal should you need to confirm latest information.