

Avbolt® 21021



For installation information please refer to the tooling overview and manuals on our website www.avdel-global.com.
 Pour les conditions de pose, merci de vous référer à la description de l'outil et aux manuels disponibles sur notre site Web.
 Angaben zur Verarbeitung entnehmen Sie bitte der Geräteübersicht und den Betriebsanleitungen auf unserer Website.
 Per informazioni sull'installazione preghiamo consultare i manuali e la panoramica degli attrezzi sul nostro sito web.
 Para ver información sobre máquinas de colocación, consulte nuestra página web, apartados visión general de máquinas y manuales.

English	Français	Deutsch	Italiano	Español	***
Body: Carbon steel* Zinc plated Clear trivalent passivated	Corps: Acier* Revêtement zingué Passivation claire trivalente	Hülse: Stahl* Verzinkt Klar chromatiert, Cr6-frei	Corpo: Acciaio* Zincata Passivazione chiara trivalente	Cuerpo: Acero al carbono* Zincado Pasivado claro trivalente	 240 h
Stem: Carbon steel** Black oxide	Tige: Acier** Noir	Dorn: Stahl** Schwarz brüniert	Gambo: Acciaio** Passivato nero	Vástago: Acero al car- bono** Pavonado	 8 h

*: SAE 1008 EN 10263-2 C8C **: SCM 435 SAE 4135 EN 10263-4 34CrMo4
 ***: to red rust / à la rouille rouge / bis Rotrost / alla ruggine rossa / al óxido rojo (ASTM B117)

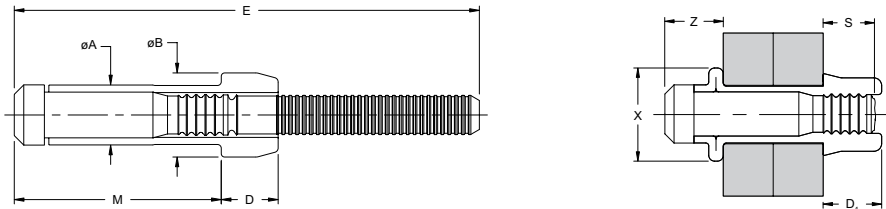

ø					øA	øB	D	D ₁	E	M	S	X	Z			Part No/ref
	nom.	min.	max.	min.												
4.8 (3/16")	2.36	3.99	5.28	5.64	5.20	7.32	4.95	5.26	37.11	12.41	6.38	7.54	5.35	12.40	8.00	21021-00602
	3.99	5.59							38.69	14.01						21021-00603
	5.59	7.16							40.27	15.59						21021-00604
	7.16	8.76							41.84	17.19						21021-00605
	8.76	10.34							43.41	18.76						21021-00606
	10.34	11.94							44.99	20.36						21021-00607
	11.94	13.51							46.56	21.94						21021-00608
	13.51	15.11							48.14	23.54						21021-00609
	15.11	16.69							49.71	25.11						21021-00610
	16.69	18.29							51.29	26.71						21021-00611
	18.29	19.89							52.86	28.29						21021-00612
	6.4 (1/4")	2.36							3.99	7.04						7.42
3.99		5.59	47.32	18.11	21021-00803											
5.59		7.16	48.89	19.69	21021-00804											
7.16		8.76	50.47	21.29	21021-00805											
8.76		10.34	52.04	22.86	21021-00806											
10.34		11.94	53.62	24.46	21021-00807											
11.94		13.51	55.19	26.04	21021-00808											
13.51		15.11	56.77	27.64	21021-00809											
15.11		16.69	58.34	29.21	21021-00810											
16.69		18.29	59.92	30.81	21021-00811											
18.29		19.89	61.49	32.39	21021-00812											

all dimensions in mm / en millimètres / alle Maße in mm / in millimetri / en milímetros



www.avdel-global.com





© 2010 Infastech

Avbolt® is a trademark of Avdel UK Limited

02.2010, page 1/2

Data shown is subject to change without prior notice as a result of continuous product development and improvement policy.
 Your local Avdel representative is at your disposal should you need to confirm latest information.

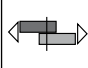
Avbolt® 21021

ø nom.					øA max.	øB max.	D max.	D ₁ max.	E min.	M max.	S max.	X nom.	Z max.	 kN min.	 kN min.	Part No/ref
	min.	max.	min.	max.												
8.0 (5/16")	4.78	7.95	8.84	9.35	8.76	12.39	8.61	9.20	62.42	23.31	10.25	12.28	9.10	36.47	23.57	21021-01004
	7.95	11.13							65.57	26.49						21021-01006
	11.13	14.30							68.72	29.66						21021-01008
	14.30	17.48							71.87	32.84						21021-01010
	17.48	20.65							75.02	36.01						21021-01012
	20.65	23.83							78.17	39.19						21021-01014
	23.83	26.97							81.32	42.36						21021-01016

all dimensions in mm / en millimètres / alle Maße in mm / in millimetri / en milímetros

Note / Note / Hinweis / Nota / Nota

Bodies are supplied lubricated and must not be degreased.

Les corps sont lubrifiés et ne doivent pas être dégraissés.

Hülsen sind mit einem Gleitmittel beschichtet, welches nicht entfernt werden darf.

I corpi sono forniti lubrificati e non devono essere sgrassati.

Los cuerpos se suministran lubricados y no deben ser desengrasados.