

# Avbolt® 21021



For installation information please refer to the tooling overview and manuals on our website [www.avdel-global.com](http://www.avdel-global.com).  
 Pour les conditions de pose, merci de vous référer à la description de l'outil et aux manuels disponibles sur notre site Web.  
 Angaben zur Verarbeitung entnehmen Sie bitte der Geräteübersicht und den Betriebsanleitungen auf unserer Website.  
 Per informazioni sull'installazione preghiamo consultare i manuali e la panoramica degli attrezzi sul nostro sito web.  
 Para ver información sobre máquinas de colocación, consulte nuestra página web, apartados visión general de máquinas y manuales.

English	Français	Deutsch	Italiano	Español	***
Body: Carbon steel* Zinc plated Clear trivalent passivated	Corps: Acier* Revêtement zingué Passivation claire trivalente	Hülse: Stahl* Verzinkt Klar chromatiert, Cr6-frei	Corpo: Acciaio* Zincata Passivazione chiara trivalente	Cuerpo: Acero al carbono* Zincado Pasivado claro trivalente	 240 h
Stem: Carbon steel** Black oxide	Tige: Acier** Noir	Dorn: Stahl** Schwarz brüniert	Gambo: Acciaio** Passivato nero	Vástago: Acero al car- bono** Pavonado	 8 h

\*: SAE 1008 EN 10263-2 C8C \*\*: SCM 435 SAE 4135 EN 10263-4 34CrMo4  
 \*\*\*: to red rust / à la rouille rouge / bis Rotrost / alla ruggine rossa / al óxido rojo (ASTM B117)

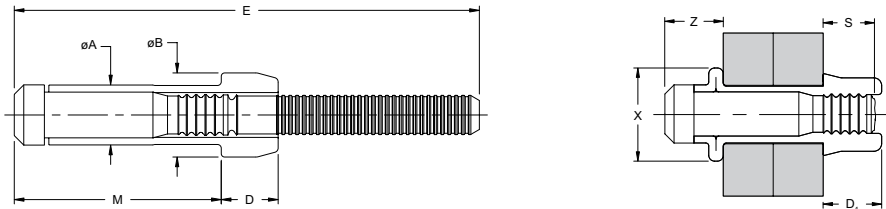

ø					øA	øB	D	D <sub>1</sub>	E	M	S	X	Z			Part No/ref
	nom.	min.	max.	min.												
3/16" (4.8 mm)	.093	.157	.208	.222	.205	.288	.195	.207	1.461	.488	.252	.297	.210	2800	1800	21021-00602
	.157	.220							1.523	.551						21021-00603
	.220	.282							1.585	.614						21021-00604
	.282	.345							1.647	.677						21021-00605
	.345	.407							1.709	.738						21021-00606
	.407	.470							1.771	.801						21021-00607
	.470	.532							1.833	.864						21021-00608
	.532	.595							1.895	.927						21021-00609
	.595	.657							1.957	.988						21021-00610
	.657	.720							2.019	1.051						21021-00611
	.720	.783							2.081	1.114						21021-00612
	1/4" (6.4 mm)	.093							.157	.277						.292
.157		.220	1.863	.713	21021-00803											
.220		.282	1.925	.775	21021-00804											
.282		.345	1.987	.838	21021-00805											
.345		.407	2.049	.900	21021-00806											
.407		.470	2.111	.963	21021-00807											
.470		.532	2.173	1.025	21021-00808											
.532		.595	2.235	1.088	21021-00809											
.595		.657	2.297	1.150	21021-00810											
.657		.720	2.359	1.213	21021-00811											
.720		.783	2.421	1.275	21021-00812											

all dimensions in inches / en pouces / alle Maße in Zoll / in pollici / en pulgadas



[www.avdel-global.com](http://www.avdel-global.com)





© 2010 Infastech

Avbolt® is a trademark of Avdel UK Limited

02.2010, page 1/2

Data shown is subject to change without prior notice as a result of continuous product development and improvement policy.  
 Your local Avdel representative is at your disposal should you need to confirm latest information.

# Avbolt® 21021

ø nom.					øA max.	øB max.	D max.	D <sub>1</sub> max.	E min.	M max.	S max.	X nom.	Z max.				Part No/ref
	min.	max.	min.	max.										lbf min.	lbf min.		
5/16" (8.0 mm)	.188	.313	.348	.368	.345	.488	.340	.362	2.457	.917	.404	.483	.358	8200	5300		21021-01004
	.313	.438							2.581	1.042							21021-01006
	.438	.563							2.705	1.167							21021-01008
	.563	.688							2.829	1.292							21021-01010
	.688	.813							2.953	1.417							21021-01012
	.813	.938							3.077	1.542							21021-01014
	.938	1.062							3.201	1.667							21021-01016

all dimensions in inches / en pouces / alle Maße in Zoll / in pollici / en pulgadas

Note / Note / Hinweis / Nota / Nota

Bodies are supplied lubricated and must not be degreased.

Les corps sont lubrifiés et ne doivent pas être dégraissés.

Hülsen sind mit einem Gleitmittel beschichtet, welches nicht entfernt werden darf.

I corpi sono forniti lubrificati e non devono essere sgrassati.

Los cuerpos se suministran lubricados y no deben ser desengrasados.